

COMMERCIAL/INDUSTRIAL

PRODUCT INFORMATION

PUNCHING PATTERNS FOR CEES AND ZEES

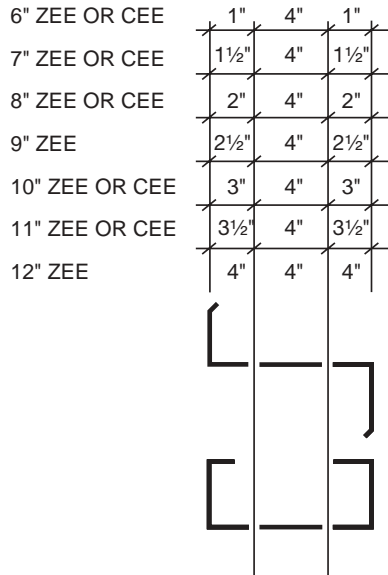

Pattern G
Common End

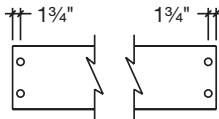

Pattern A

(See page CI-16 for lap options)

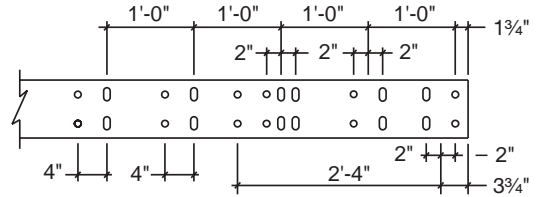

Pattern B

(See page CI-17 for lap options)

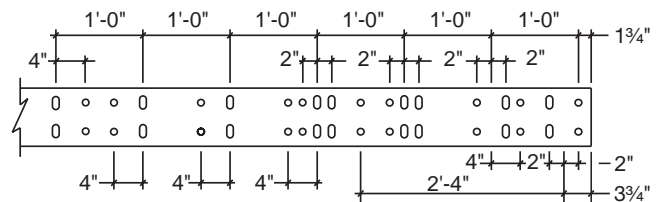

NOTES:

1. Web punching is available on all 6"-10" Zees and Cees and 12" Zees
2. Please inquire for 4" Zee or Cee Special Web punching availability.

Pattern D & E - Common Flange

(See Note 1)

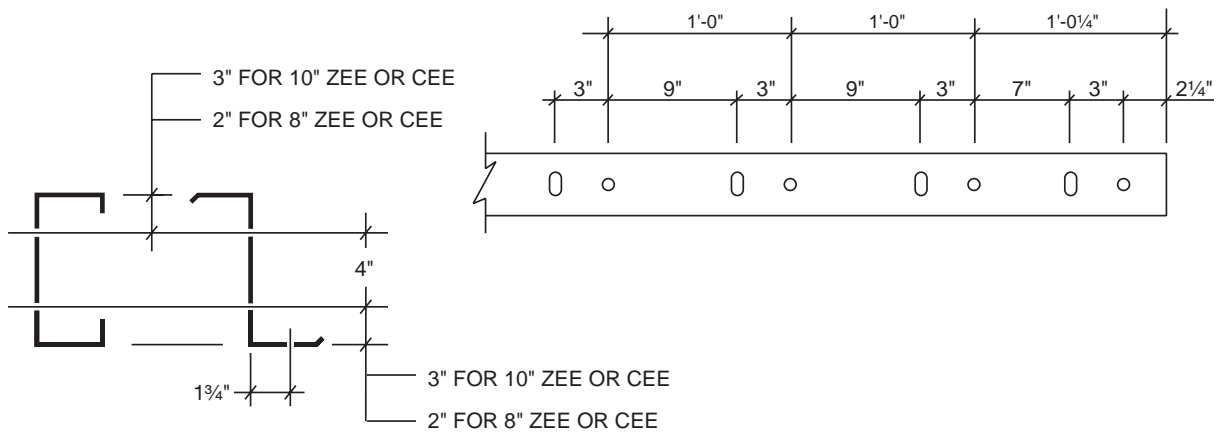

NOTES:

1. Common flange punching Pattern D has Pattern A in the web. Common flange punching Pattern E has Pattern B in the web.
2. Flange punching is not available on 4" or smaller Cees and Zees.
3. All holes are 5/8".
4. All slots are 5/8" X 3/4".
5. Consult the Light Gage Structural Institute (LGS) Manual for engineering information.